



Exhibition

Table Top Exhibition Space at the Conference Foyer

Take the opportunity to showcase and promote your company, products and activities. Exhibit space is limited and available only on a first come first served basis, so sign up early!

The exhibition package includes:

- Draped table and two chairs 2,5 x 1,2 m
- Full access to the conference center
- 2 coffee & refreshment breaks
- Midday business luncheon
- Evening networking cocktail party
- Your company name and logo continuously featured on www.europeantunaconference.com
- Your company name and logo published in the Conference Booklet

The exhibitor will receive a Conference Kit with full conference documentation, as well as a USB key containing all the conference speeches and the complete list of participants to the event.

The rate for a Table Top Exhibition Space at the Conference Foyer is Euro 940 (21% Belgian VAT already included).

Floor Plan

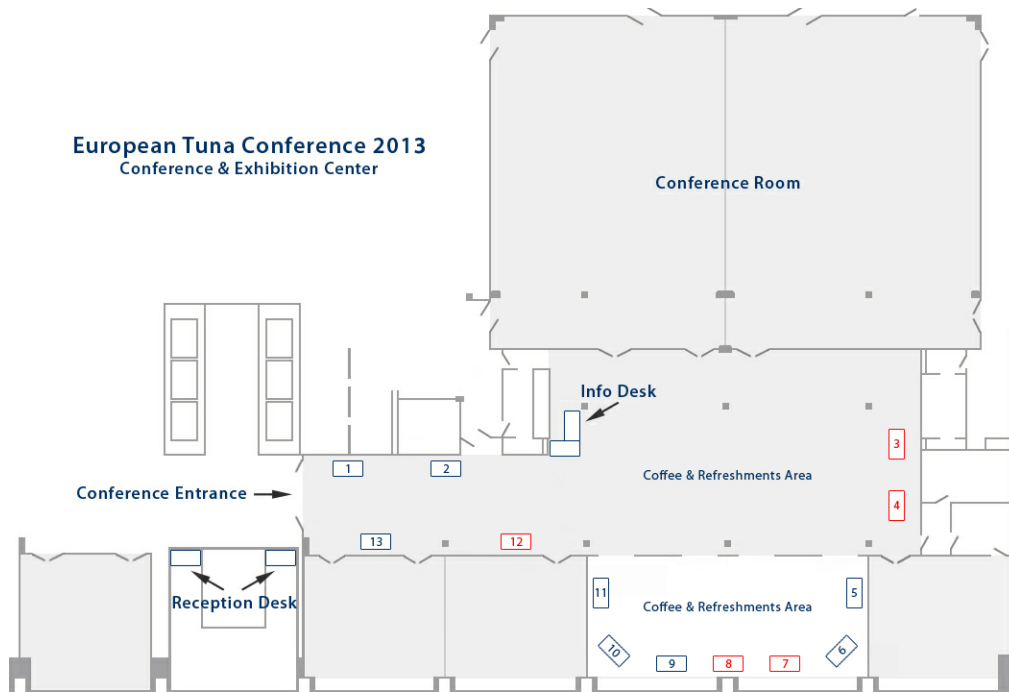

1 = Available
2 = Available
3 = Neogen
4 = Kroma
5 = Available
6 = Available
7 = CLS

8 = PT Samudra Mandiri Sentosa
9 = Available
10 = Available
11 = Available
12 = Somtuna
13 = Available

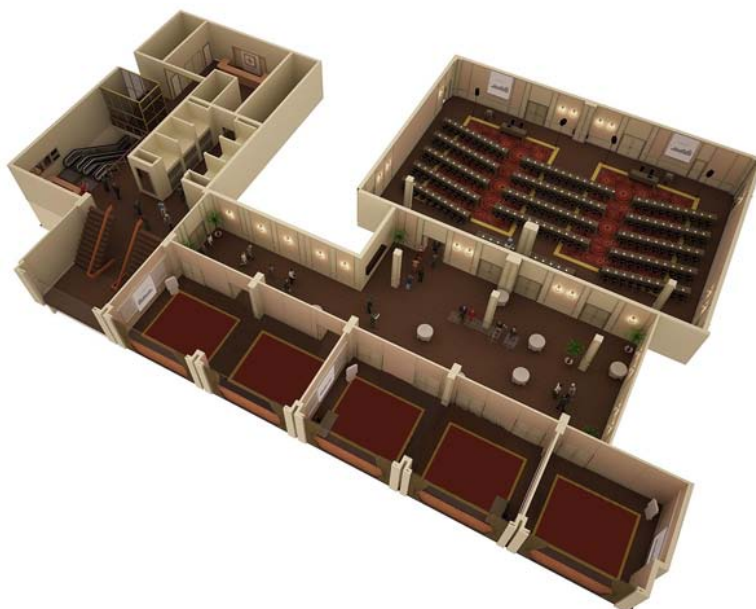

Material & Equipment

Table top exhibition package includes:

Draped table 2,5 x 1,2 m and two chairs. Additional furnishing can be supplied upon request:

Additional furnishing can be supplied upon request:

Plasma TV 43 inch	Euro 400 (21% VAT not included)
Roll up banner, full color, 85 x 200 cm w/h	Euro 150 (21% VAT not included)
LCD TV 26 inch	Euro 150 (21% VAT not included)
LCD TV 21 inch	Euro 90 (21% VAT not included)

Rates & Conditions

Take the opportunity to showcase and promote your company, products and activities. Exhibit space is limited and available only on a first come first served basis, so sign up early!

The rate for a Table Top Exhibition Space at the Conference Foyer is Euro 875 (21% Belgian VAT already included)

The table top exhibition package is for one participant. More delegates from your company are welcome to participate. As exhibitor, your company may register additional exhibiting personnel at the special rate of Euro 360 + 21% VAT per person.

VAT

Certain EU regulations permit VAT paid in member countries to be reclaimed. For further information, please contact your local tax authorities.

Payment Policy

Exhibition rates are to be paid within 7 days from confirmation date.

Refund & Cancellation Policy

- If cancellation is received at least 45 days before the event, there will be a 75% refund.
- If cancellation is received between 45 and 21 days prior to the event, there will be a 25% refund.
- No refunds will be granted for cancellations later than April 1st.
- If Atuna.com cancels the event -for any reason- the exhibitor will receive full refund.

Interested in exhibiting at the European Tuna Conference 2013 next April 22nd in Brussels, Belgium?

Please let us know by sending us a message at support@europeantunaconference.com - we will get in touch with you as soon as possible.